

# SEO CANblu app

user manual

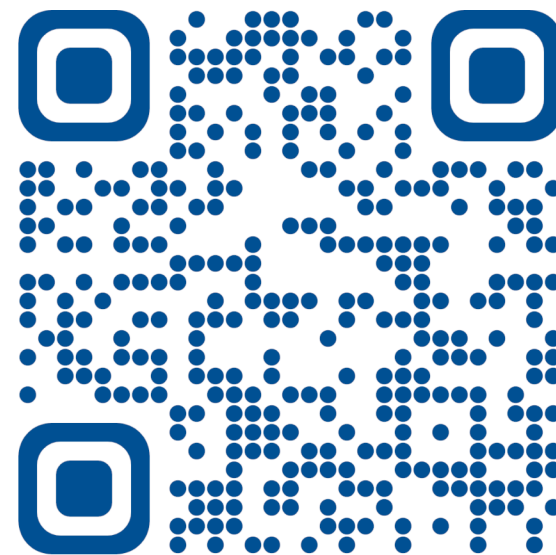

# INTERFACE

App interface - view when SEO CANblu app is not paired with immobilizer

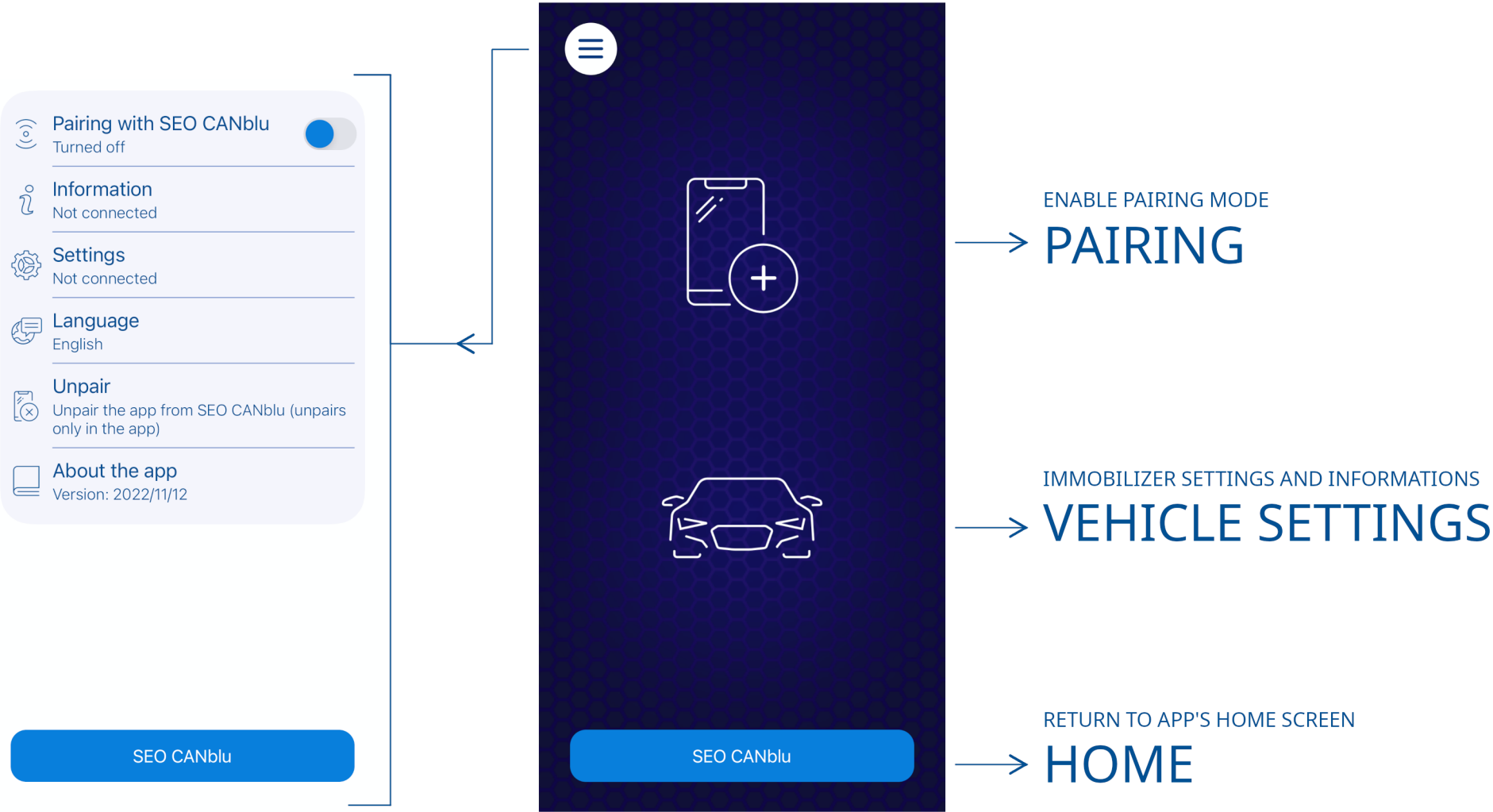

# PAIRING

## Pairing procedure - SEO CANblu app with immobilizer

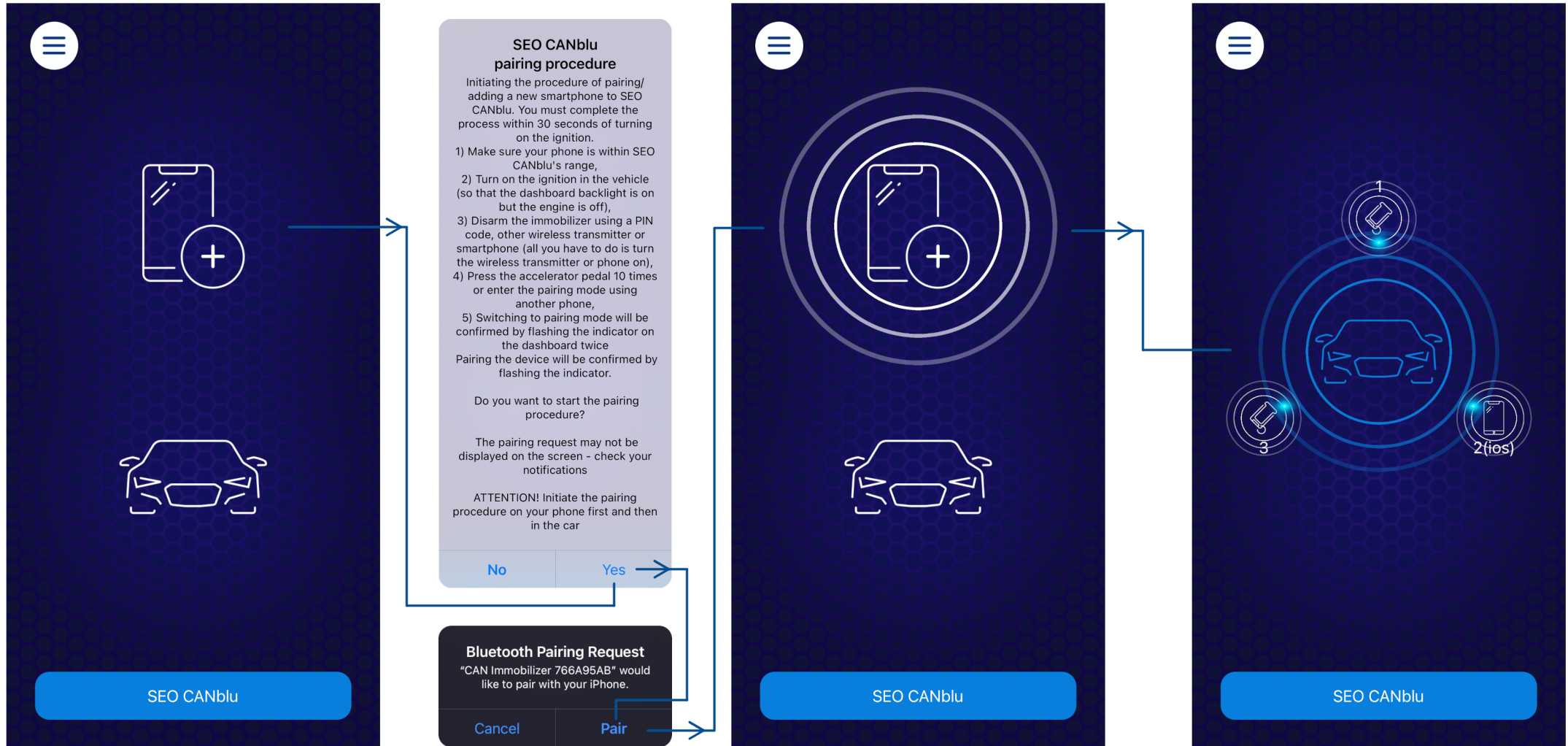

# MENU

App interface - view when SEO CANblu app is paired with immobilizer

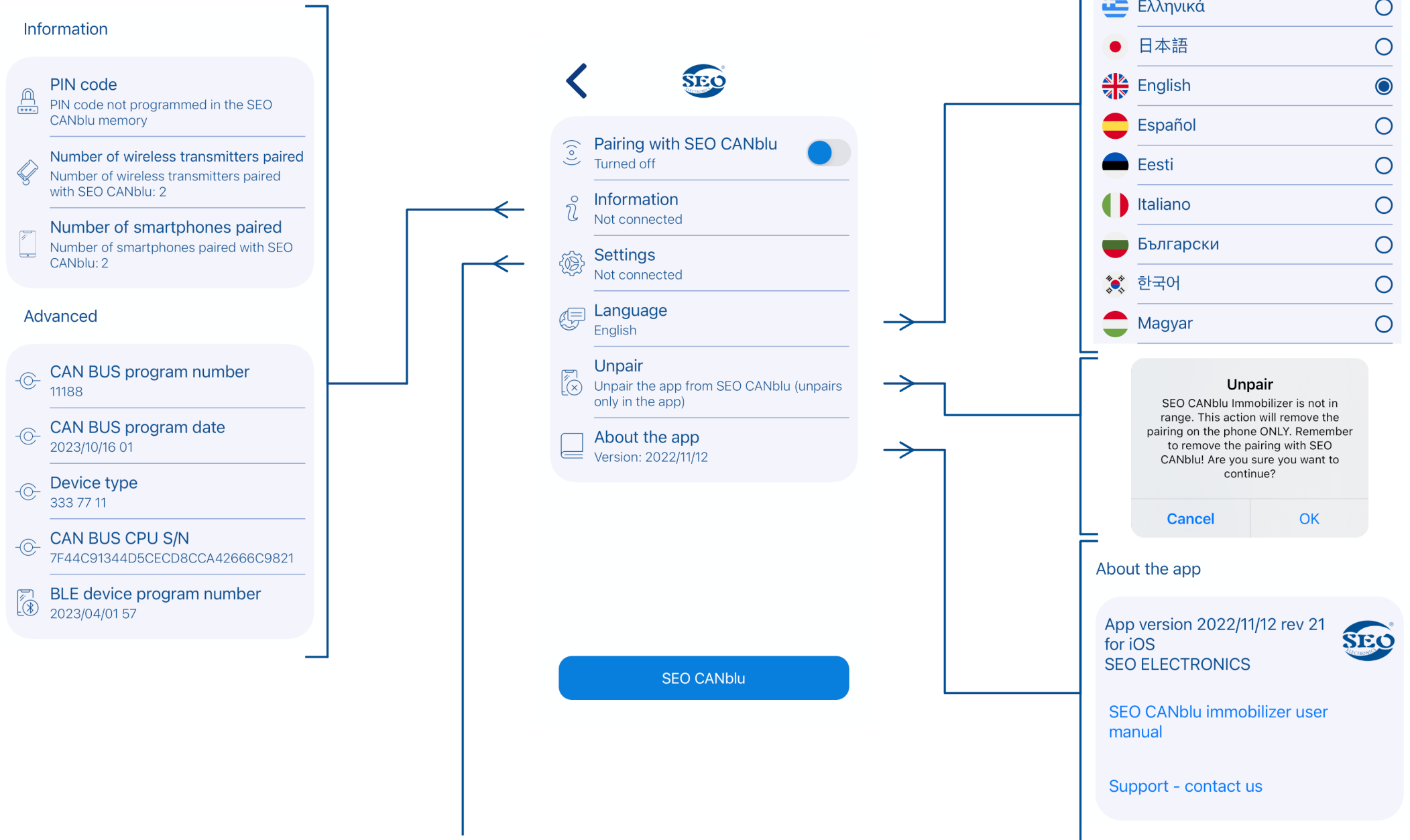

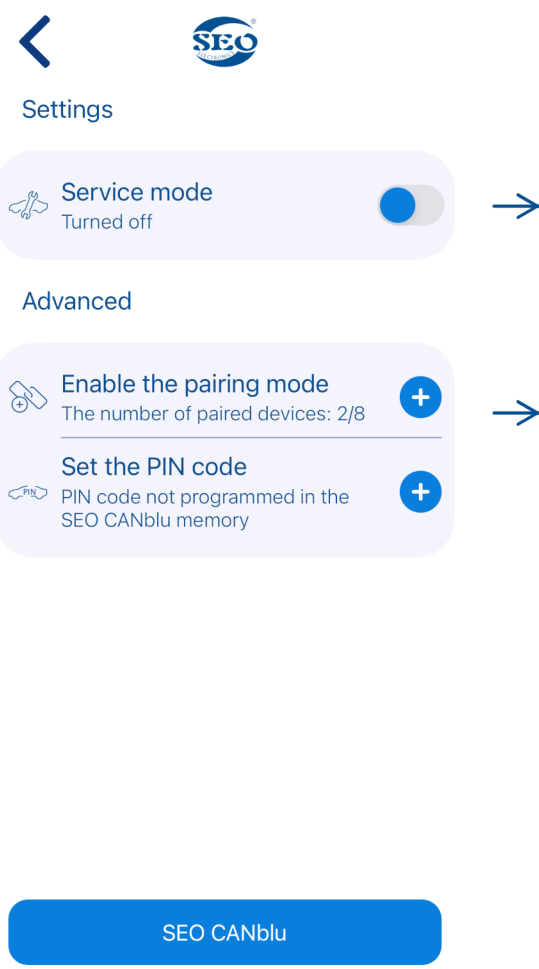
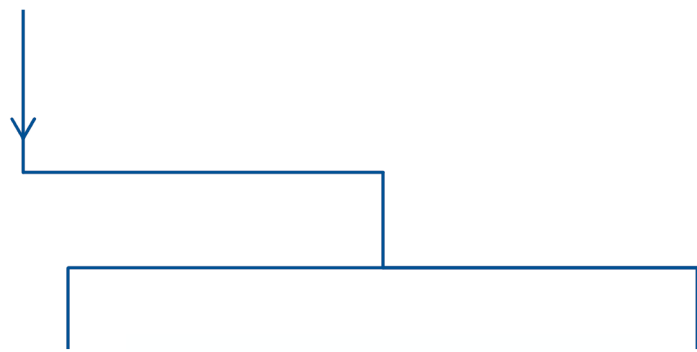

**Programming procedure**

Initiating the procedure of pairing/programming a new smartphone or wireless transmitter. Complete the entire process within 30 seconds of switching on the ignition. Make sure the wireless transmitter is not paired with another SEO CANblu immobilizer, switched on and within SEO CANblu range. Immediately after entering the programming procedure, press the wireless transmitter button once. Start the pairing procedure using the phone. For the procedure to be successful, you need to do it shortly after switching on the ignition - a new device must appear within the range of SEO CANblu within 30 seconds of switching on the ignition

Cancel      OK

**Service mode**

Caution! Activating the service mode disables vehicle protection. You can switch on the service mode only within 60 seconds of switching on the ignition (with the engine switched off). Remember to disable the service mode when you pick up the vehicle from the service. Activation of the service mode will be confirmed by flashing the indicator in the vehicle 5 times

Cancel      OK

**Programming procedure**

Initiating the procedure of programming the PIN code using the buttons available in the vehicle - the list is available in the connection diagram or with the installer. For the procedure to succeed, you must complete it shortly after switching on the ignition - start entering the PIN code within 30 seconds of switching on the ignition. After pressing all the PIN code buttons, turn the ignition off so that the key combination will be saved

Cancel      OK

SEO CANblu